

Welcome



The City of Swift Current has contracted Associated Engineering Ltd. to prepare an concept plan to inform the future redevelopment of the St. Patrick School site.

The City is committed to preserving the existing school building and enhancing the existing open space area. To make this process as transparent and participatory as possible, the City invites you to take some time this evening to browse the information presented on the display boards and engage the project team in discussions regarding your perspectives related to the plan or process. The input received from this event will be documented in the final report and may potentially inform further refinements to the plan prior to finalizing the report.

While reviewing the information presented, please keep the following questions in mind and be sure to take a few minutes before you leave to document your perspectives on the comment sheets provided:

- **How do you currently utilize the park?**
- **What do you like most about the proposed plan?**
- **What changes (if any) would you recommend to improve the plan?**

Design Objectives



Prior to the preparation of a preliminary concept plan, Associated Engineering facilitated a design charrette workshop with the City Administration to identify the vision and overall objectives for redeveloping the St. Patrick school site. It was during this workshop that the following design objectives were developed:

- **Redevelop the school site for a community multi-purpose sports field, and neighborhood scale park space**
- **Retain the school building for reuse with the exception of the portables located north of the building**
- **Accommodate multiple recreation functions, including non-programmed activities and design for year-round use**
- **Provide open space opportunities for all residents, regardless of age, income, culture, or physical ability**
- **Locate and design open space that provides access, parking, and circulation appropriate for the intended level of activity**
- **Create an internal trail system with the opportunity for future connection to the City's existing trail system**

Site Plan Rendering

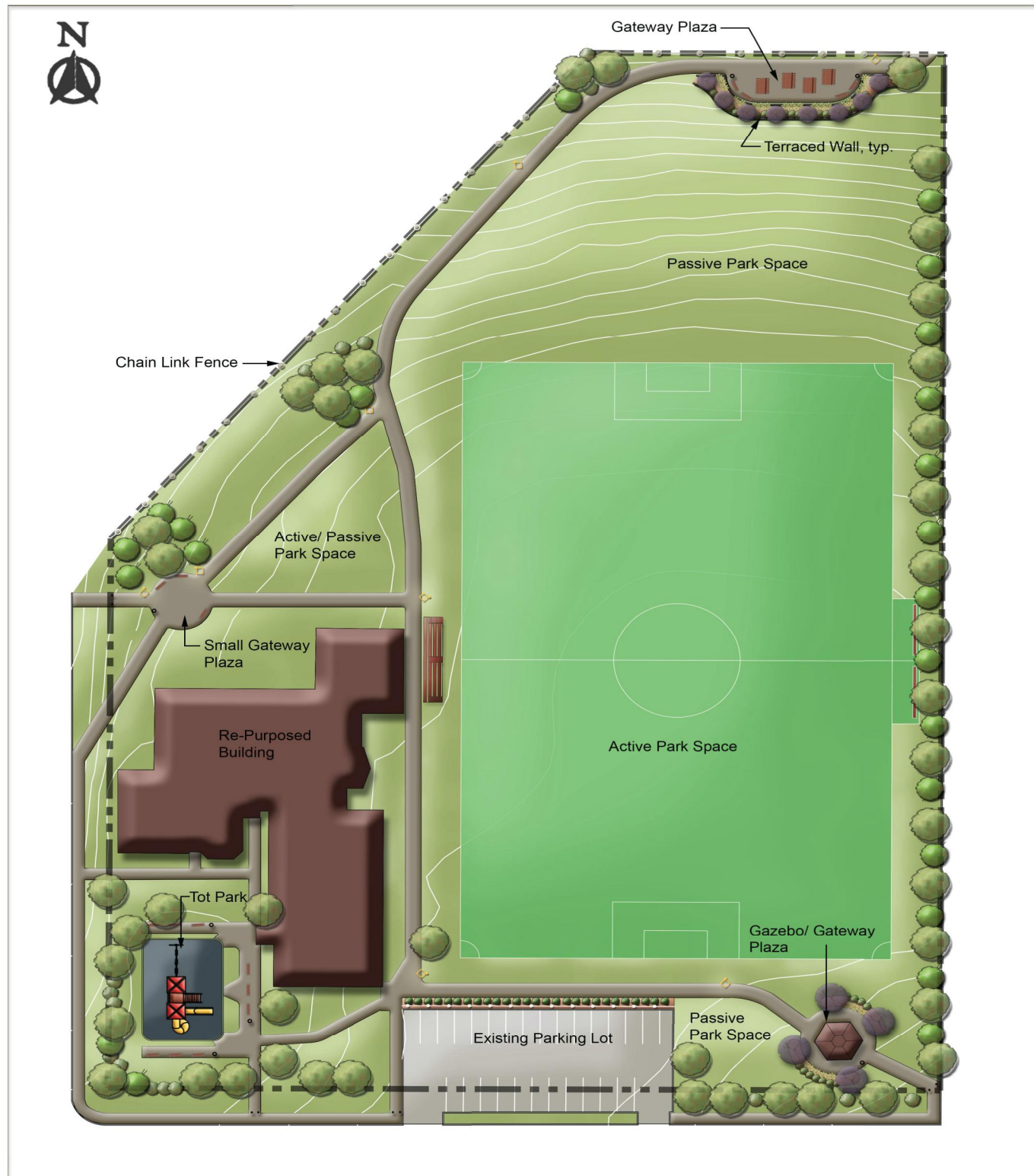

The focus of the site plan is a centrally located sports field sized to accommodate sanctioned soccer events. This field would also host a variety of programmed or informal community activities including ultimate Frisbee, field lacrosse and hockey, football or rugby. Although formal seating is not envisioned at this point, area has been set aside along west side of the sport field to accommodate the placement of bleachers.

A tot park is proposed in the southwest corner of the site adjacent to the school building. The tot park would include a formal playground structure placed on rubber surface. The tot park would also include bench seating along the north, east, and south boundaries of the park. Trees and shrubs are planned to be placed along the western and southern periphery of the site to provide a physical separation between the tot park and the adjacent roadways.

In addition to the formal recreational spaces described above, the plan provides an abundance of open space throughout the site to accommodate a wide range of passive recreational pursuits including but not limited to walking, jogging, bird watching, reading and picnics.

The plan provides for an internal network of asphalt surfaced pedestrian pathways throughout the site connecting pedestrians and cyclists with all features within the park and destinations outside of the St. Patrick site. An opportunity exists to connect this site with the Chinook Trail pathway system by extending a pathway along Highway No. 1 from Dufferin Street West to Grey Street West. Once connected to Grey Street West, pedestrians/cyclists would need to use the existing sidewalks to access the Chinook Trail at Kiwanis Park adjacent to Central Avenue North.

Bird's-eye View



Park Entrances



Entrance Features

One of the key objectives of any public space is to make it attractive to potential users. There are four proposed entrances on the four corners of the site. Each entrance is designed to welcome people into the area and encourage them to stay and enjoy the facilities. There are three plaza areas defined by bench seating and plantings. These plazas are located at the intersection of the internal pathways and provide an opportunity for people to congregate (i.e. gazebo) or view the activities on the sports field. Each plaza area is intended to be well lit to ensure safe navigation through the park at all hours.

Design Summary



Sports Field

The dimensions of the sports field is 68 metres x 105 metres to accommodate formal sanctioned soccer events. The sports field is intended to be slightly elevated from the surrounding areas to promote good drainage with a perimeter swale to gather run-off and convey it away from the site. The sports field will have space set aside along the east sideline for player benches and spectator area along the western boundary of the field.

Tot Park

A tot park has been conceptually placed in the southwest corner of the St. Patrick site area. The location was selected based on visibility from the building and access from the pathways. It will include a playground structure with pour in place rubber as opposed to sand which will make this playground accessible to all residents. The play area will be surrounded by grass and the pathway which connects with perimeter seating and garbage receptacles.



Design Summary

Parking

The existing parking lot currently provides 20 parking spots and will remain in its location to provide off-street parking for the sports field and tot park. Once these spaces are full, it is anticipated people will park along adjacent local roads such as Lorne Street West.

As the existing school building is intended to be re-purposed for a new use, it is expected that the parking lot would also continue to support this future use as well.

Grading

The site grading needs to be carefully planned out to provide the site with optimal opportunity to be a true four season park space. The hill along the north-end of the site is expected to be developed for a dual purpose. The hill is anticipated to provide an area to view activities on the sports field during the active sports season while also retaining the ability to be used as a toboggan hill during the winter months. Based upon Sled Safe Guidelines, the toboggan hill would be classified as an intermediate hill which is considered suitable for ages 7 and up.

Fencing

The site is currently fenced with chain link fencing materials. This fencing will be removed along the southern and eastern boundaries and replaced with perimeter tree plantings with a high canopy to provide a visually attractive and natural physical barrier separating vehicle areas from non-vehicular areas. Trees also provide visual amenity and shade for park users.

The chain link fence is expected to remain in place along the northern boundary to provide visibility into the open space area while creating a physical barrier to prevent vehicle access into the open space.

Lighting

Lighting will be located along the pathways to illuminate the pathways during times when it is dark out. The City typically requires a lighting fixture every 50 metres along a pathway and the Preliminary Open Space Concept Plan has located lighting fixtures following this distance. The entrances have been provided additional lighting to promote visibility and safety upon entering the space. The multi-purpose sports field is not anticipated to have lighting and events will be played during times of daylight.

Next Steps

Following this Public Open House we will:

- Review your comments;
- Finalize open space concept plan for the St. Patrick School Site; and
- Finalize the St. Patrick School redevelopment project concept plan report.

Please fill out a comment sheet before you go to ensure your voice is heard and considered as part of the St. Patrick School redevelopment project.

